

GP-1000

- * Pilot operated piston type
- * Superior durability
- * Stable performance
- * Valve leakage meets ANSI Class IV
- * High reduction ratio (20:1)



Feature		Piston type / Ductile cast iron / Flanged
Type		Pilot operated piston type
Specifications	Application	Steam
	Inlet pressure	0.1 - 1.0MPa
	Reduced pressure	0.05 - 0.9MPa
	Connection	JIS 10K FF flanged
	Adjustable reduced pressure	90% or less of the inlet pressure(gauge pressure)
	Min. differential pressure	0.05MPa
	Max. pressure reduction ratio	20:1
	Max. temperature	220 degree(C)
Material	Body	Ductile cast iron
	Valve	Stainless steel
	Valve seat	Stainless steel
	Piston, cylinder	Brass or bronze

Dimensional drawing

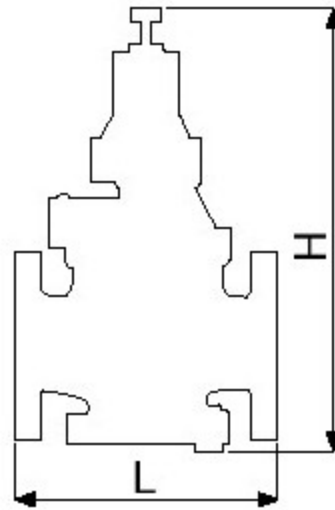

Size	L (mm)	H (mm)	Weight (kg)	Cv value
15A(1/2)	150	285	8.0	1
20A(3/4)	155	285	8.5	2.3
25A(1)	160	300	10.0	4
32A(1-1/4)	190	323	14.0	6.5
40A(1-1/2)	190	323	14.5	9
50A(2)	220	347	20.0	16
65A(2-1/2)	245	357	30.0	25
80A(3)	290	404	35.0	36
100A(4)	330	450	52.5	64